

**NORWOOD GREEN  
OSMOND TOWER  
100 Magill Road,  
NORWOOD SA 5067**

**TYPE 02**

Internal Area 88m<sup>2</sup>

External Area 19m<sup>2</sup>

**TOTAL AREA 107m<sup>2</sup>**



Magill Road

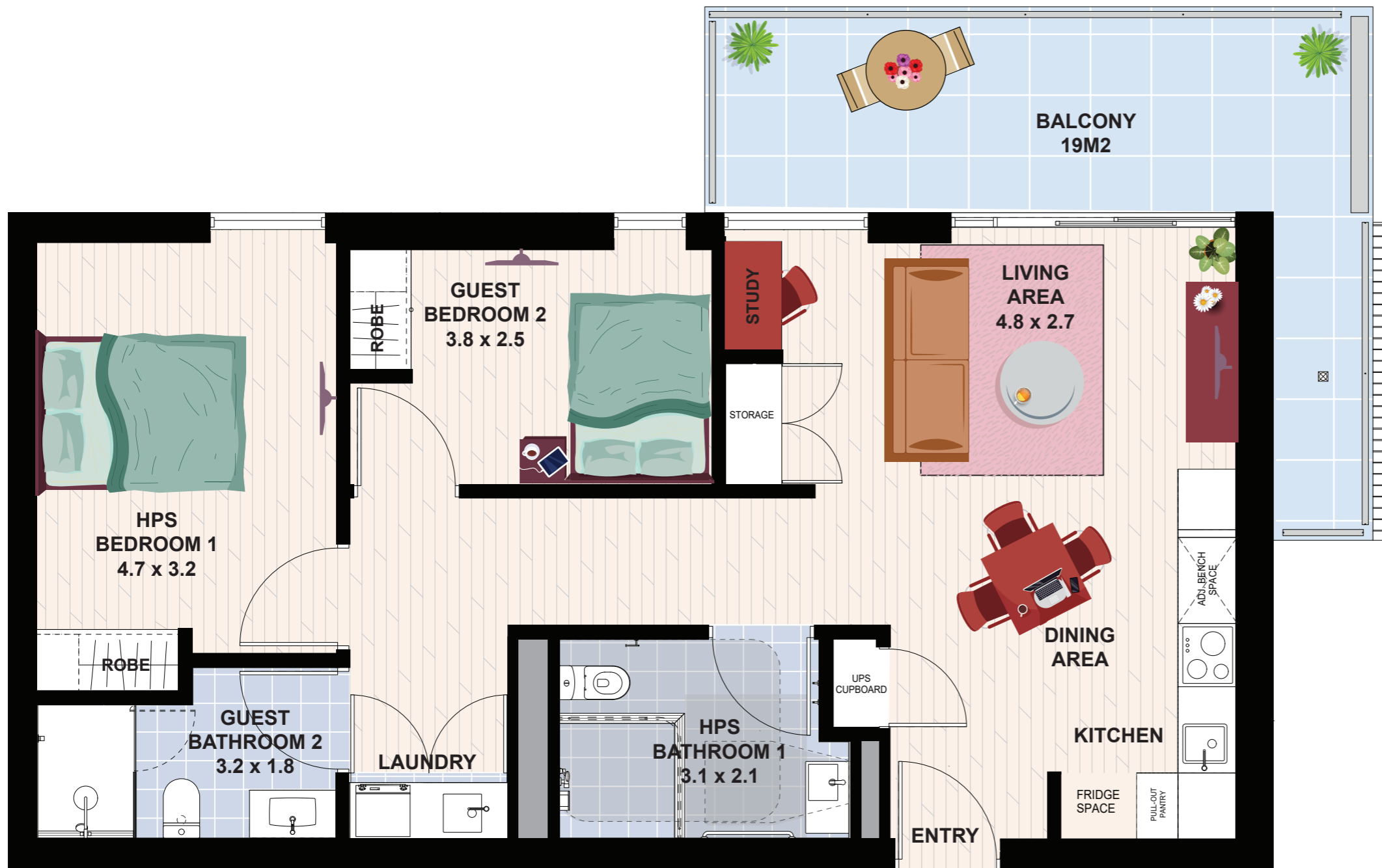
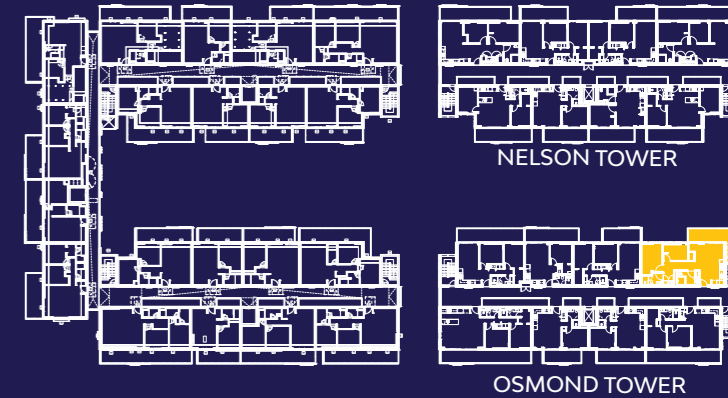

**NOTE: DESIGNS SUBJECT TO CHANGE**



**IMPROVED  
LIVEABILITY**



**FULLY  
ACCESSIBLE**



**HIGH PHYSICAL  
SUPPORT**

**enliven** HOUSING

**Enquiries 1300 ENLIVEN  
enlivenhousing.com.au**

