

MARTIN & POWLETT
 9 Martin St, 12 Powlett St
 HEIDELBERG VIC 3084

TYPE 06

Internal Area 76 m²

External Area 7 m²

TOTAL AREA 83 m²

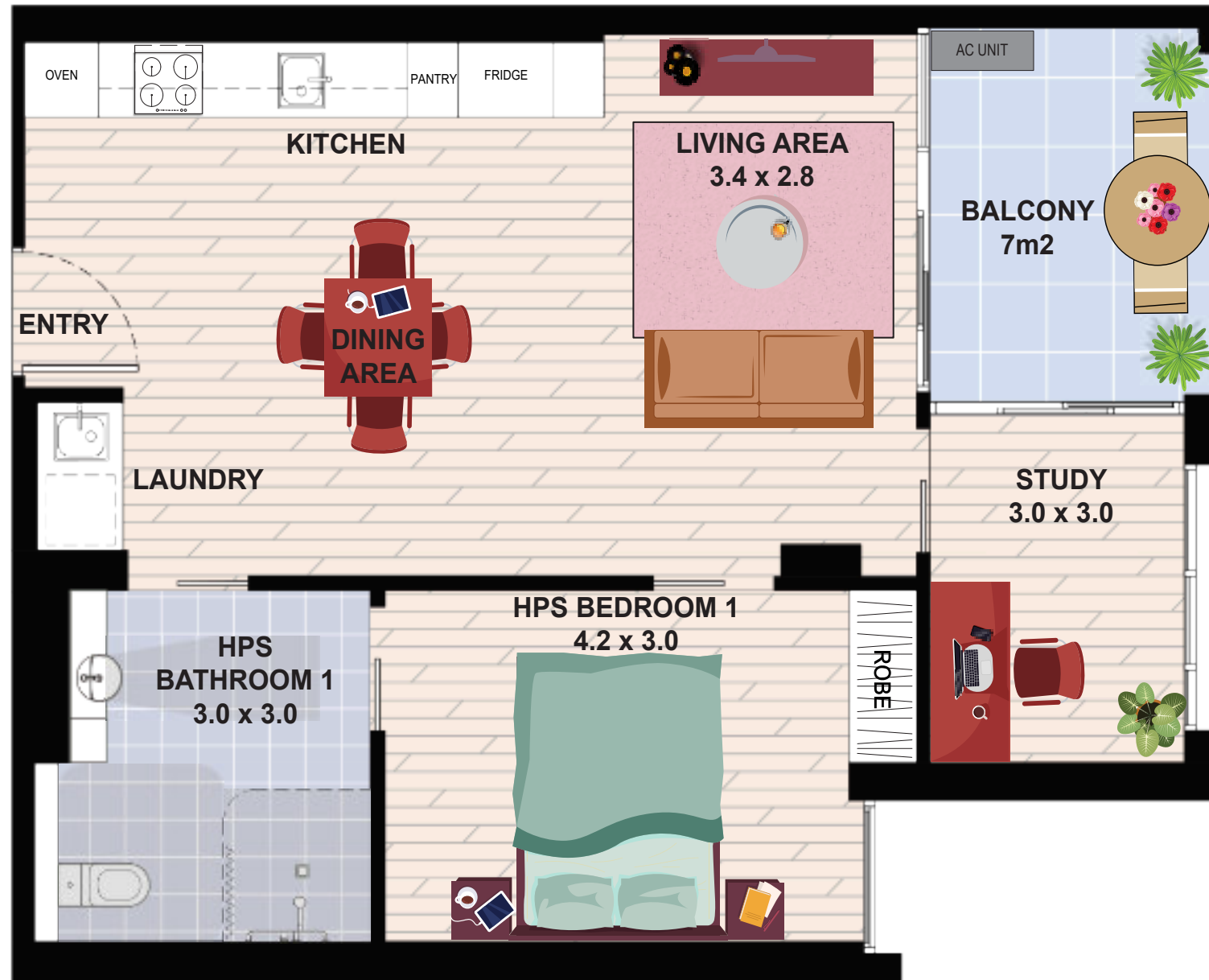

NOTE: DESIGNS SUBJECT TO CHANGE



IMPROVED
LIVEABILITY



FULLY
ACCESSIBLE



HIGH PHYSICAL
SUPPORT

enliven HOUSING

Enquiries 1300 ENLIVEN
 enlivenhousing.com.au

